

## RESOLUTION NUMBER 7280

**WHEREAS**, the Mayor and City Council of the City of Beatrice, Nebraska desire to stimulate redevelopment of the Stoddard Elementary School Site, and to include said school site in Redevelopment Area No. 2, by designating this area as being substandard and blighted as defined in Neb. Rev. Stat. §18-2103; and

**WHEREAS**, the designation of a certain area as substandard and blighted is a prerequisite to the adoption of a Redevelopment Plan and the use of Tax Increment Financing for use in redevelopment efforts; and

**WHEREAS**, on February 5, 2024, the City retained Hanna:Keelan Associates, P.C. to conduct a blight/substandard determination study of the Stoddard Elementary School Site and amend the general redevelopment plan for Redevelopment Area No. 2 to include the Stoddard Elementary School Site therein, which was completed in March 2024; and

**WHEREAS**, on April 12, 2024, the Community Redevelopment Authority of the City of Beatrice recommended that the Stoddard Elementary School Site be declared to be a substandard and blighted area in need of redevelopment; and

**WHEREAS**, on April 15, 2024, the Planning and Zoning Commission of the City of Beatrice recommended that the Stoddard Elementary School Site be declared to be a substandard and blighted area in need of redevelopment; and

**WHEREAS**, the Mayor and City Council of the City of Beatrice, Nebraska, find and determine that the Stoddard Elementary School Site, as shown in Exhibit "A", is substandard and blighted as defined in Neb. Rev. Stat. §18-2103.

NOW, THEREFORE, BE IT RESOLVED BY THE MAYOR AND CITY COUNCIL OF THE CITY OF  
BEATRICE, NEBRASKA:

**SECTION 1.** The Stoddard Elementary School Site, as shown in Exhibit "A", be and is  
hereby declared to be a substandard and blighted area in need of redevelopment.

**SECTION 2.** That all resolutions or parts of resolutions in conflict herewith are hereby  
repealed.

RESOLUTION PASSED AND ADOPTED this 15<sup>th</sup> day of April, 2024.

Attest.

  
Erin Saathoff, CMC, City Clerk  
Mike McLain, Acting Mayor

# CONTEXT MAP

REDEVELOPMENT AREA #2 WITH AMENDMENT AREA  
BEATRICE, NEBRASKA  
ILLUSTRATION 1

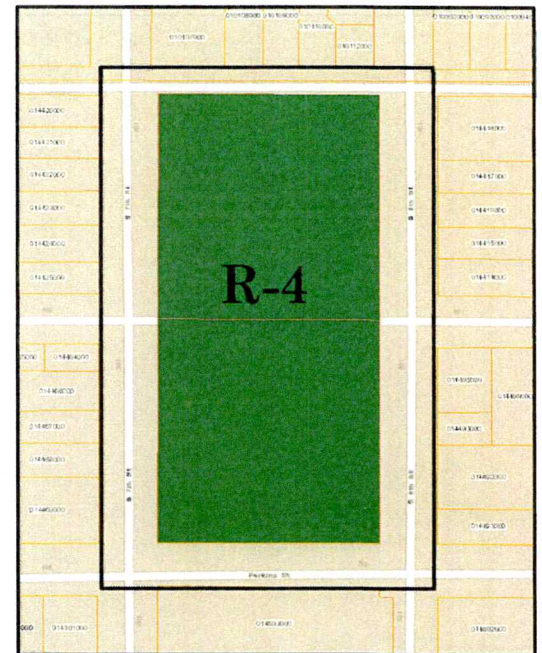
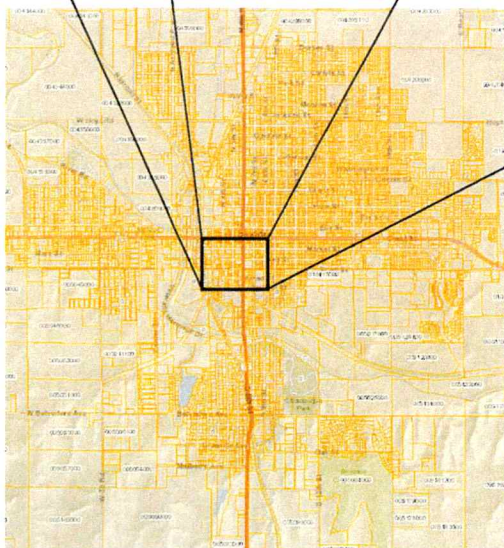
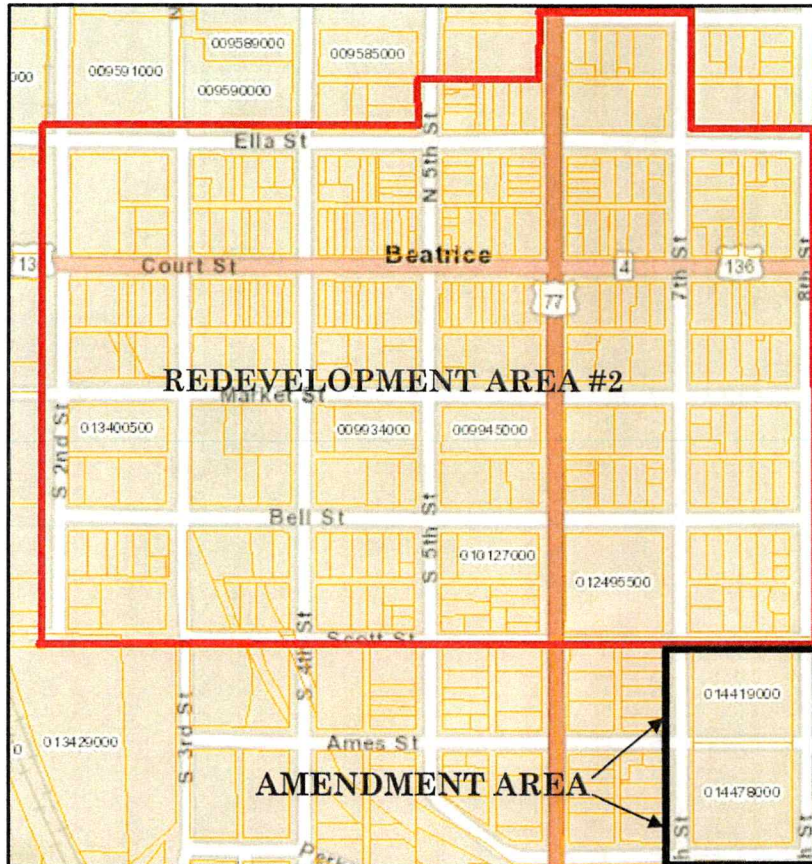

## LEGEND

- PUBLIC/QUASI-PUBLIC LAND USE
- R-4 - MULTIPLE FAMILY RESIDENTIAL ZONING DISTRICT
- REDEVELOPMENT AREA #2 BOUNDARY
- AMENDMENT AREA BOUNDARY

